

That part of the NW 1/4 of Section 2, T3N, R15E, in the Town of Richmond, Walworth County, Wisconsin, bounded and described as follows: Commencing at the center of said Section, said center being 2635.68 feet S 88° 29' 23" West of the SE corner of the NE 1/4 of said Section 2; thence 88° 34' 51" West, along the South line of said NW 1/4 of said Section 2, 1046.08 feet to the point of beginning; continuing thence S 88° 34' 51" West, along said South line 265.00 feet to a point being the SW corner of the SE 1/4 of the NW 1/4 of said Section 2, thence N 0° 24' 48" West, along the West line of the East 1/2 of the NW 1/4 of said Section 2, 424.34 feet to a point; thence N 73° 32' 03" East 652.92 feet to a point being a center of a 100 foot radius cul-de-sac, thence S 2° 51' 54" East 100.00 feet to a point in the South line of said cul-de-sac; thence S 35° 49' 48" West 620.36 feet to the point of beginning.

RECEIVED
JAN 20 1997
dey

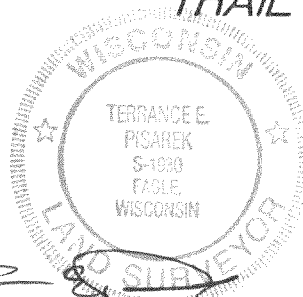
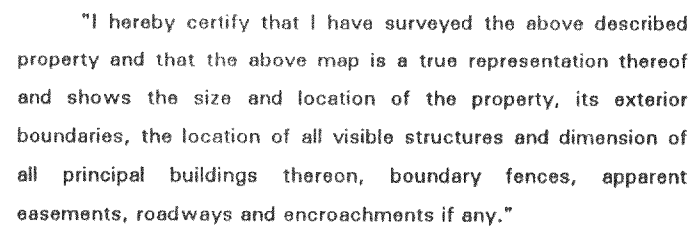

(414) 594-3484
fax (414) 594-5904

96170
JOB NUMBER

CR-2-27

315-568